

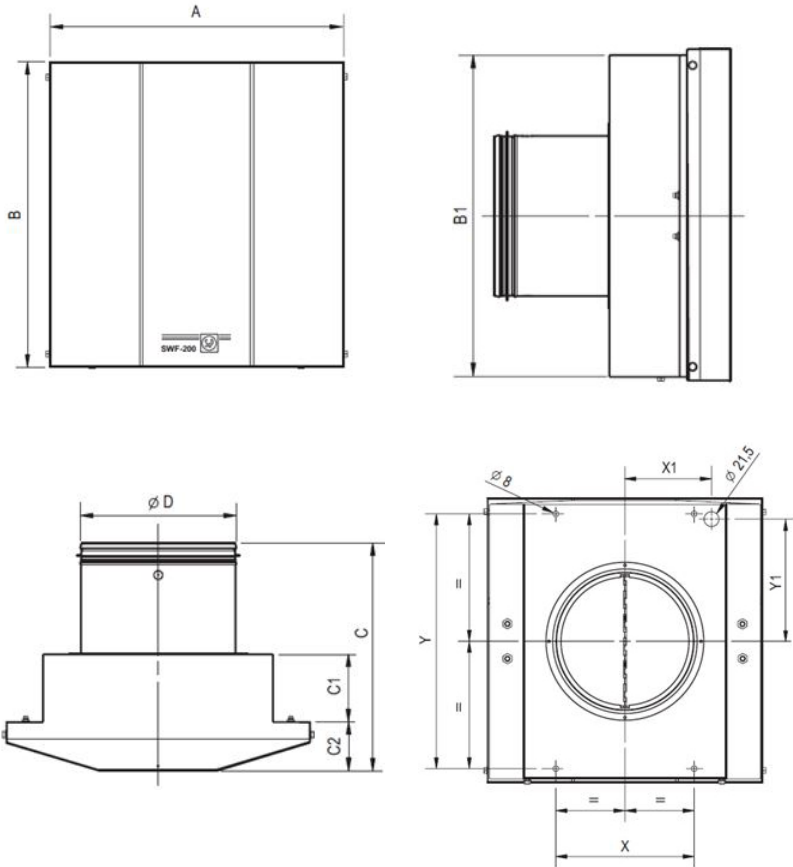

The Dragon

Standard Features

- Manufactured from high grade pressed galvanized steel, with baked enamel coating.
- Removable top for easy access to motor for cleaning or inspection.
- Large grille opening for easy passing of lint and other potentially clogging materials.
- Supplied with a prewired junction box.
- Backward curved centrifugal impeller.
- Factory matched to an external rotor motor and dynamically balanced to eliminate vibration.
- Totally enclosed permanent split capacitor start and run external rotor motor.
- 120V 60Hz (single phase) electrical connection.
- Permanently sealed, self-lubricating precision ball bearings
- Safety Thermal Overload Protection Cut-Out (Automatic Reset Type).
- All Models are suitable for working airstreams up to 140° F



Dimensions (In Inches):

Model	A	A1	B	B1	C	C1	C2	D	X	X1	Y	Y1
DR-150	13-1/4	9-11/16	13-1/4	12-7/8	10-1/4	3-3/16	2-7/16	6	5-29/32	3-15/16	11-5/8	5-1/2
DR-200	15-9/16	11-9/16	16-1/16	15-11/16	11-7/16	3-7/16	2-7/16	8	7-27/32	4-29/32	14-13/32	6-29/32

Specifications:

Model	RPM	Current (A)	Watts	CFM vs Static Pressure (SP) in WG								
DR-150	2600	0.8	90	235	221	197	181	168	122	81	60	27
DR-200	2800	1.0	115	416	395	368	341	324	287	233	184	132



Please contact us if you have any questions and to learn more about switches and optional controls.

TAMARACK
Ventilation

info@tamtech.com
774-678-4433